

WELCOME TO THE CITY OF MORE

 **PROVIDENT
SUNWORTH CITY**

NEAR MYSORE ROAD,
NICE JUNCTION, BENGALURU

Provident Sunworth City=Provident Equinox II
<https://rera.karnataka.gov.in/>



EXPERIENCE HOMES DESIGNED FOR MORE

Established in 2008, Provident Housing Limited is a large-scale community developer offering the great value within the residential segment. The company caters to the diverse residential needs of buyers, with a focus on aspirational home ownership. A 100% subsidiary of Puravankara Limited, Provident Housing carries its legacy with a portfolio of remarkable residential developments.

With proven competencies, Provident Housing thoughtfully conceives every space with a blend of unique design aesthetics, innovation, and technology. The company espouses the 'YOU' philosophy of customer-centricity, which focuses on enhancing customer experience and creating value for our home buyers. It combines this credo with **value, trust, and quality** to offer an exceptional community living experience that aims to elevate customers' lifestyles with homes designed for more.



15 Years of trust

9 Project presence across cities

12.8 Million sq. ft. delivered

50,000+ Happy customers

12,000+ Homes delivered

5000+ Homes in the making

**WE BELIEVE
IN THE
POWER
OF MORE**



OUR BELIEFS



MORE VALUE
We strive to bring you a holistic living experience within a thriving community.



MORE TRUST
Uncompromising integrity is the way of life at Provident.



MORE QUALITY
Our work is built on modern technique, meticulous detailing, and industry expertise.

OUR WAY FORWARD

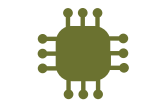

MORE TECHNOLOGY
We pay close attention to making our homes future-ready.



MORE SUSTAINABILITY
We put nature at the centre of our processes and efforts.



MORE TRANSPARENCY
Respect for our consumers translates to adoption of honest practices.



THE CENTRE OF POSSIBILITIES & GROWTH

South Bengaluru exudes the old-world charm as some of the old renowned localities are located here.

Mysore Road is also surrounded by prominent places of worship, lending the the region with rich heritage value.

With several investments and cutting-edge infrastructure cropping up, South Bengaluru presents alluring opportunities for the future, making it every home buyer's dream.

CONNECTIVITY



The project is situated near NICE Junction, which connects the city's northern and southern suburbs, and provides a signal-free corridor between Hosur & Tumkur Road. A bus terminal, a railway station and two metro stations- particularly the Challaghatta Metro Station is within reach. With the current metro infrastructure, one can easily reach Central Bengaluru in 30 minutes. And with more metro phases being proposed and under development, Provident Sunworth City is a gold mine of connectivity.

ECONOMIC CORRIDOR



The only residential neighbourhood connected to both IT and Manufacturing Hubs, provide employment to millions. The Bidadi Industrial Area spread across -860 acres, housing some of the most prominent MNCs, along with Toyota, Bosch, Hindustan Coca-Cola Beverages, to name a few. Global Village Tech Park, spread over 120 acres with a total built-up area of 3.3 million sq.ft., has some of the most eminent IT/ITES like Accenture, Capgemini, Mindtree, etc.

HEALTHCARE & EDUCATION



The micro-market has seen a steady growth in its social infrastructure development, with it becoming a prominent hub for healthcare and education. Raja Rajeshwari Medical College, a well-reputed hospital, is just 1 km from the property. Within the 10 km radius, 5-6 prominent hospitals like BGS Gleneagles Global and Medsol are located. There are around 20+ Schools and 12+ Colleges & Universities are present in the area with premier educational institutes like Tattva School, IBS School of Management & R.V. College of Engineering.

TOURISM CORRIDOR



Mysore Road, now a 10-lane Expressway, is a major tourism corridor, connecting picturesque hill stations in Tamil Nadu, Kerala, and Karnataka, so weekend plans are never canceled over traffic woes. Just 5 minutes away from the project, it ensures that one cruise through the traffic and reach Mysore in just 90 minutes.

LOCATION MAP



LOCATION HIGHLIGHTS

COMMUTE

- Challaghatta Metro Station - 2 km
- NICE Road Junction - 3 km
- Kengeri Metro Station - 3 km
- Kengeri Railway Station - 5 km
- Kengeri Bus Terminal - 6 km

OFFICES

- Global Village Tech Park - 7 km
- Bidadi Industrial Estate - 18 km
- Hindustan Coca Cola Beverages Ltd - 18 km
- Toyota Kirloskar Motor Pvt. Ltd. - 19 km

HOSPITALS

- Raja Rajeshwari Medical College and Hospitals - 1 km
- Raja-Rajeshwari Dental College and Hospitals - 4 km
- BGS Hospital - 6 km
- Medisol Hospital - 7 km

ENTERTAINMENT

- Good Earth Eco Tourism - 1 km
- Grips Gokarting and Clubbing - 3 km
- Decathlon - 4 km
- The Garden Asia Resort - 5 km
- Gopalan Arcade Mall - 10 km
- Wonderla - 12 km

SCHOOLS

- National Public School - 4 km
- Marigold International School - 5 km
- Gurukula Vidya Peetha School - 6 km
- Gopalan National School - 6 km
- Tattva School - 9 km

COLLEGES

- ACS College of Engineering - 500 m
- RR College of Engineering - 5 km
- Don-Bosco Institute of Technology - 6 km
- RV College of Engineering - 9 km
- Bangalore University - 10 km

GOOGLE COORDINATES:
12.887163, 77.468694

PROVIDENT SUNWORTH CITY=
PROVIDENT EQUINOX II

THE DREAM OF EMBRACING THE CITY

Bengaluru is a metropolitan city that celebrates the culture of community living. A city which openly engulfs you with sounds and sights of nature and biodiversity, welcomes a 60-acre gated community that amasses the spirit of this phenomenal city.

In an era where people have limited time for loved ones, Provident Sunworth City comes through like a glimmer of hope. A flawless property built within the city, we've created a sanctum filled with love, laughter, and homeliness, with beautiful apartments, and an estate that captures the essence of an unparalleled sanctuary.

Let your escape be your home.





NOW ENTERING PROVIDENT SUNWORTH CITY

Imagine the home of your dreams.

Does it come alive in a city surrounded by nature?

Where your health thrives as you walk around the vast open spaces and enjoy a sport of your choice?

Where every little convenience is only a quiet walk away?

A place where you belong to a community of people that soon become family?

Then, we welcome you to Provident Sunworth City.



TO BUILD A HOME

Here, where culture is reborn, resides a community that respects old family values.

A neighbourhood that lives life the right way, in an area where the wind carries less pollution, and the skyline holds a mesmerizing view of the dense trees, away from the hustle.

Provident Sunworth City is a city of its own: one that harbors your vision of a perfect home, away from the unplanned urbanized lands, and into the soft hands of sophistication with branded fixtures that elevate your lifestyle.

Provident Sunworth City provides you with so much more than just a comfortable life.

It presents to you, on a platter, a life that helps you live maximum.



DRAW THE BLINDS TO A VIEW OF VAST LANDS

The cross-shape designed towers ensure that all homes receive ample sunlight. Out of these windows, view this efficiently planned city embellished with lush, nature-filled open spaces. Savor this sanctuary to the horizon, and breathe in the dewy smell of Bengaluru, but better.

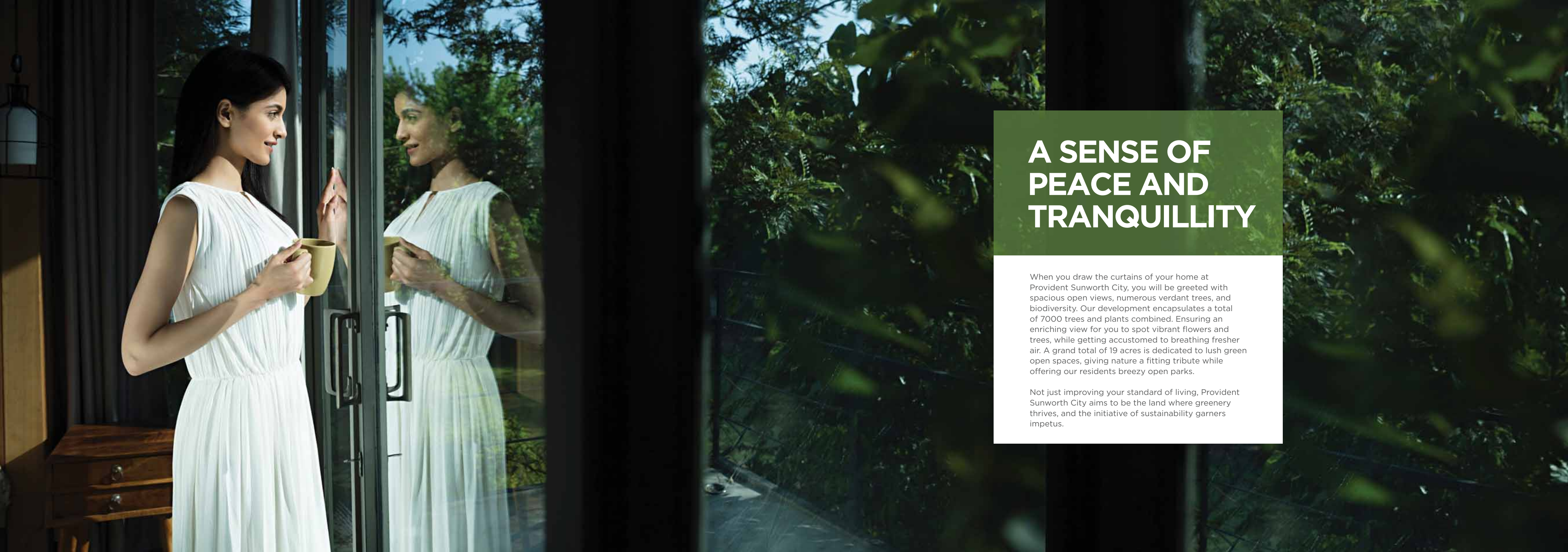

A SENSE OF PEACE AND TRANQUILLITY

When you draw the curtains of your home at Provident Sunworth City, you will be greeted with spacious open views, numerous verdant trees, and biodiversity. Our development encapsulates a total of 7000 trees and plants combined. Ensuring an enriching view for you to spot vibrant flowers and trees, while getting accustomed to breathing fresher air. A grand total of 19 acres is dedicated to lush green open spaces, giving nature a fitting tribute while offering our residents breezy open parks.

Not just improving your standard of living, Provident Sunworth City aims to be the land where greenery thrives, and the initiative of sustainability garners impetus.

MASTER PLAN



- READY AMENITIES**
- East Promenade
 - Pavilion
 - Mini Forest
 - Leisure Deck
 - South Promenade
 - Yoga Pavilion
 - Paw Park
 - Community Lawn (Mini Hockey)
 - Kids' Play Area
 - Badminton Court
 - Multipurpose Court (Kabaddi/ Volleyball)
 - Basketball Court
 - Cricket Net
 - Outdoor Tennis Court
 - Play Lawn
 - Jogging Track
 - Butterfly Garden
 - Skating Rink
 - Outdoor Exercise Court
 - Swimming Pool
 - Table Tennis
 - Multipurpose Hall
 - Carrom
 - Pool Table
 - Convenience Store
 - Reading Room
 - Gymnasium

- AMENITIES UNDER FUTURE DEVELOPMENT**
- Children's Play Area
 - Mini Bridge
 - Foot Soak
 - Rock Garden
 - Pavilion
 - Archery (As part of Jogging Track)
 - Laughter Court
 - Mini Golf
 - Party Lawn

TAKE A BREAK OR BREAK A SWEAT

Feel like going for a run before work? We got your back. Feel like taking a dip in the pool after a hard day? Not a problem. Now, whether it's a mind-boggling game of chess with a friend, a game of catch with your pet, or your little one wanting to skate around, there's room for refreshment & recreation of pretty much every kind. With 50+ lifestyle amenities, including 3 well-equipped clubhouses, take your pick from indulging in an activity indoors or taking a stroll in our vast open spaces at Provident Sunworth City.





SWIMMING POOL



GYMNASIUM



TABLE TENNIS



CHILDREN'S PLAY AREA



SKATING RINK



CRICKET PITCH



MINI FOREST



JOGGING TRACK



BASKETBALL COURT



YOGA PAVILION



PAW PARK



TENNIS COURT



PLAY LAWN

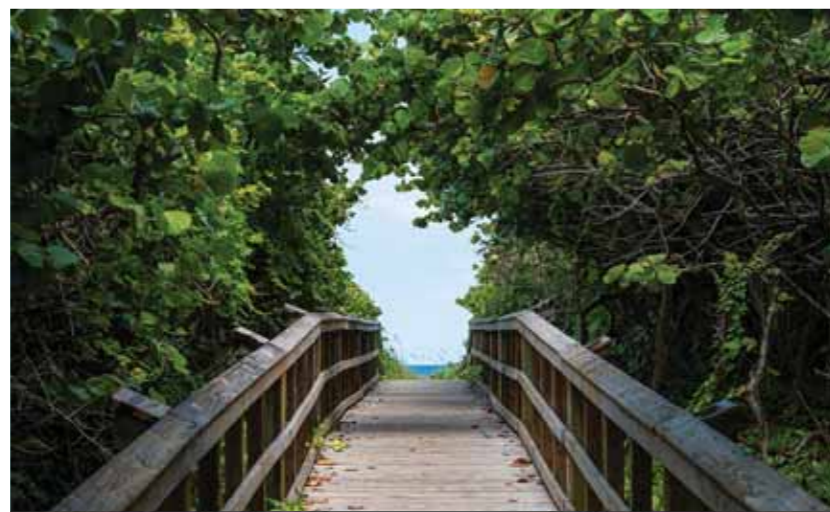

VIEWING DECK



MULTI-PURPOSE HALL



READING ROOM



POOL TABLE



CONVENIENCE STORE

TOWER PLAN

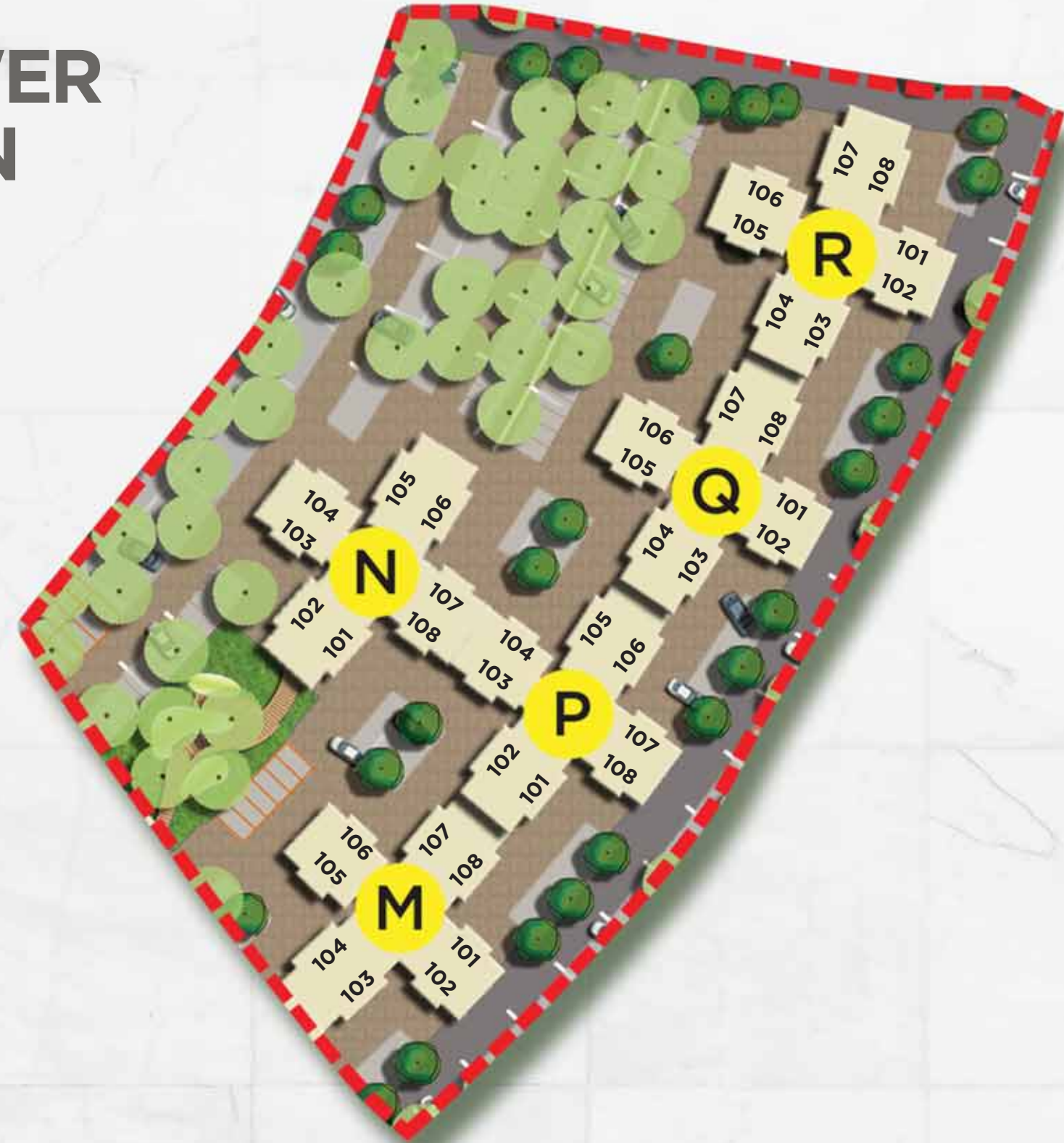

TYPICAL FLOOR PLAN

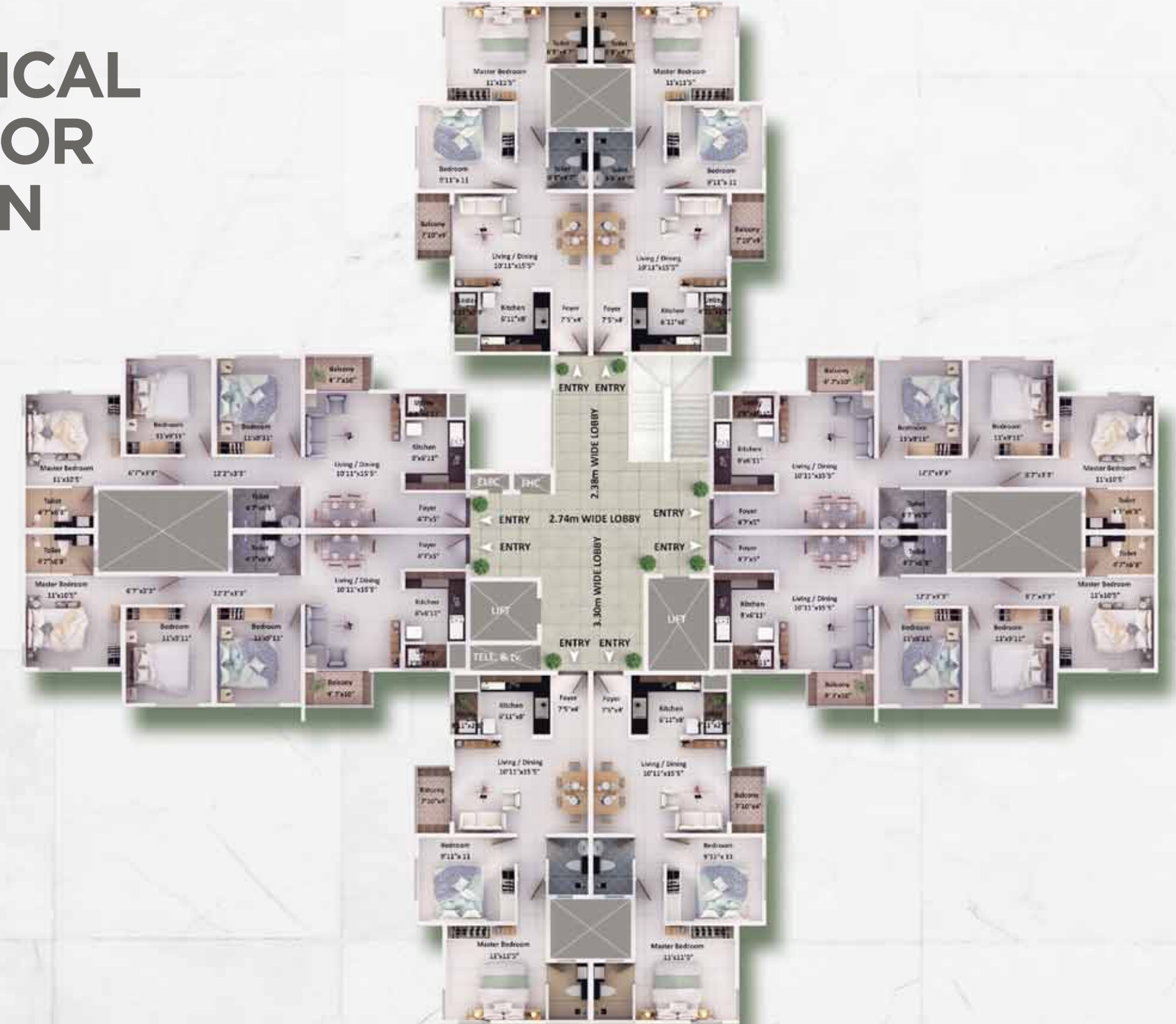

These photographs are indicative only. Floor plans are in accordance with the last approved sanctioned plan and may be subject to change mandated by governmental authorities and/or applicable law. As a measure of transparency, you are informed that the entrance to kitchen has been moved to the opposite wall in order to improve aesthetics, efficiency and privacy for home owners. There is no change in the carpet / useable area of the apartment.

TYPICAL UNIT PLAN

2 BHK

Typical Carpet Area	~ 623 sq. ft.
Typical Usable Area	~ 655 sq. ft.
Typical Saleable Area	~ 883 sq. ft.



TYPICAL UNIT PLAN

3 BHK

Typical Carpet Area	~ 773 sq. ft.
Typical Usable Area	~ 805 sq. ft.
Typical Saleable Area	~ 1082 sq. ft.



The imagery used in the brochure is indicative of style only. The photographs of the interiors, surrounding views and location may have been digitally enhanced or altered and do not represent actual views or surrounding views. These photographs are indicative only. Floor plans are in accordance with the last approved sanctioned plan and may be subject to change mandated by governmental authorities and/or applicable law.



**ADDING FEATHERS
TO OUR CAP,
YEAR ON YEAR**

2013

PAUL WRITER REAL ESTATE MARKETING CONCLAVE AND AWARDS: Outstanding Outdoor - Out of Home advertising that cuts through the clutter - Provident - Sunworth for 'I made life changing decision' campaign

2014

EMERGING DEVELOPER OF THE YEAR - Residential Provident Housing Ltd. for Sunworth at the 6th REALTY PLUS EXCELLENCE AWARDS

SKOCH ORDER-OF -MERIT AWARD received for Business process improvement, Quality Improvement & Technology Deployment, for qualifying in India's Best projects for the presentation done on Provident Sunworth

2015

7TH REALTY PLUS EXCELLENCE AWARDS for Affordable Housing Project of the Year - Provident Sunworth

8TH FRANCHISE INDIA ET NOW ESTATE AWARDS for Affordable Housing Project of the Year - Provident Sunworth

PARRYWARE NDTV PROPERTY AWARDS for Budget Apartment of the Year - Tier 1 - Provident Sunworth

2016

ACCE(I)-SARVAMANGALA AWARD 2016 for Excellence in Construction in the Field of Civil Engineering - Provident Sunworth

5TH ANNUAL 'SILICON INDIA BENGALURU REAL ESTATE AWARDS' 2016 for the 'Best Affordable Apartment Project Of The Year' - South Bengaluru' - Provident Sunworth

INDIAN CONCRETE INSTITUTE BIRLA SUPER AWARD - 2016 - Outstanding Concrete Structure of Karnataka (Building Category) - Provident Sunworth

2017

REALTY PLUS EXCELLENCE AWARDS (SOUTH) 2017 - Excellence in delivery - Provident Sunworth

2018

BAM (BUILDERS, ARCHITECTS & BUILDING MATERIAL) AWARDS 2018 for Best Affordable Housing Project - Provident Sunworth

2019

CIA WORLD CONSTRUCTION & INFRA AWARDS 2019 for the Best Township Project - Provident Sunworth

GLOBAL REAL ESTATE & BUSINESS EXCELLENCE AWARDS 2019 - Dubai - for Best Affordable Housing Project of the Year - Provident Sunworth

2022

THE ECONOMIC TIMES REAL ESTATE AWARDS 2022 - SOUTH - Best Residential Project - Mid Segment (Ongoing: Metro) - Provident Sundeck

GREEN APARTMENTS BY KARNATAKA STATE POLLUTION CONTROL BOARD for its contribution towards Sustainable development

MID-SEGMENT PROJECT OF THE YEAR at Realty+ Excellence Awards 2022, SOUTH



**PROVIDENT
SUNWORTH CITY**

NEAR MYSORE ROAD, NICE JUNCTION, BENGALURU

PRM/KA/RERA/1251/310/PR/190529/002585

RERA website: <https://rera.karnataka.gov.in/>

— **Call: 1860 258 4444** —

sales@providenthousing.com

www.providenthousing.com

Provident Sunworth City= Provident Equinox II
